

Data Sheet For:

# Clyde Dome Valve's

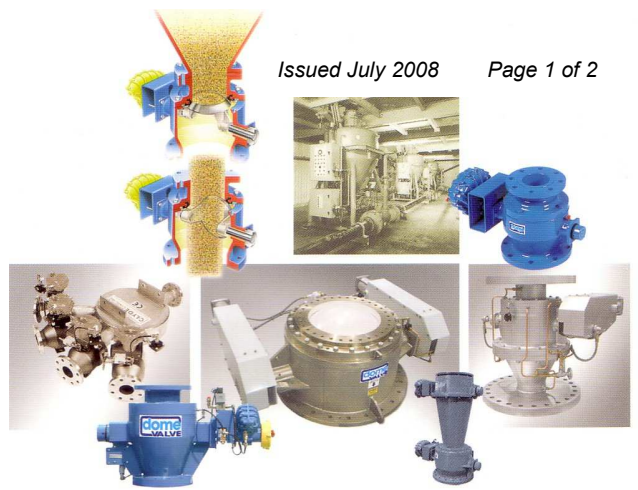

## Introduction

The operating efficiency of all Clyde Materials Handling systems relies upon the unique and patented Clyde Dome Valve, currently installed in over 15,000 applications worldwide. Simple in design and low in maintenance, this high performance valve is used throughout a wide range of industries.

In action the Clyde Dome Valve is a pressure tight compressed air operated valve, capable of returning over one million maintenance-free cycles, even in abrasive, hazardous or toxic applications. The fast-closing cut-off valve incorporates a unique inflatable sealing mechanism. This provides the pressure tight seal, against the dome surface when in the closed position.

## Inflatable sealing mechanism

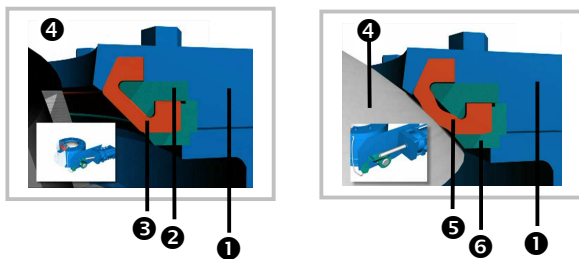

- ❶ Top Plate
- ❷ Insert Ring
- ❸ Deflated Seal
- ❹ Dome
- ❺ Inflated Seal
- ❻ Seal Retaining Ring

Before opening the seal deflates and the dome turns 90°, providing full bore opening for unobstructed material flow.

## Options

- **Actuator:** Dependant on product size, a choice of Vane or Cylinder actuated models is available on valve sizes greater than 200mm (8"). On smaller models the vane actuator is standard.
- **Customised Manufacture:** Dome Valves can be customised to meet the special requirements of most applications. Optional quality seals and internal coatings are available, applied to the Dome surface only or to the internal surfaces of the Clyde Dome Valve body or the adaptors.
- **Internal Coating Examples:** Tungsten carbide hard coating for abrasive products, hard chrome facing and ENP coatings on dome surface for sticky and abrasive products and reinforced PTFE for food applications / sticky / wet products.
- **Materials of Manufacture:** SG Iron, Carbon Steel and Stainless Steel.
- **Temperature Ratings:** -20° to 200°C for the standard Dome Valve. Up to 480°C manufactured to order.
- **Pressure Ratings:** 7 bar maximum pressure on the standard Dome Valve. Up to 30 bar manufactured to order.

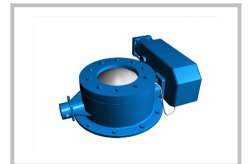

## Industry Applications

The Dome Valve is suited to applications in a wide range of industries from food to power, pharmaceutical to mineral and plastics to metals. Capable of moving or static column cut off, the valve handles abrasive, cohesive, fine and dry



# Data Sheet For: Clyde Dome Valve's

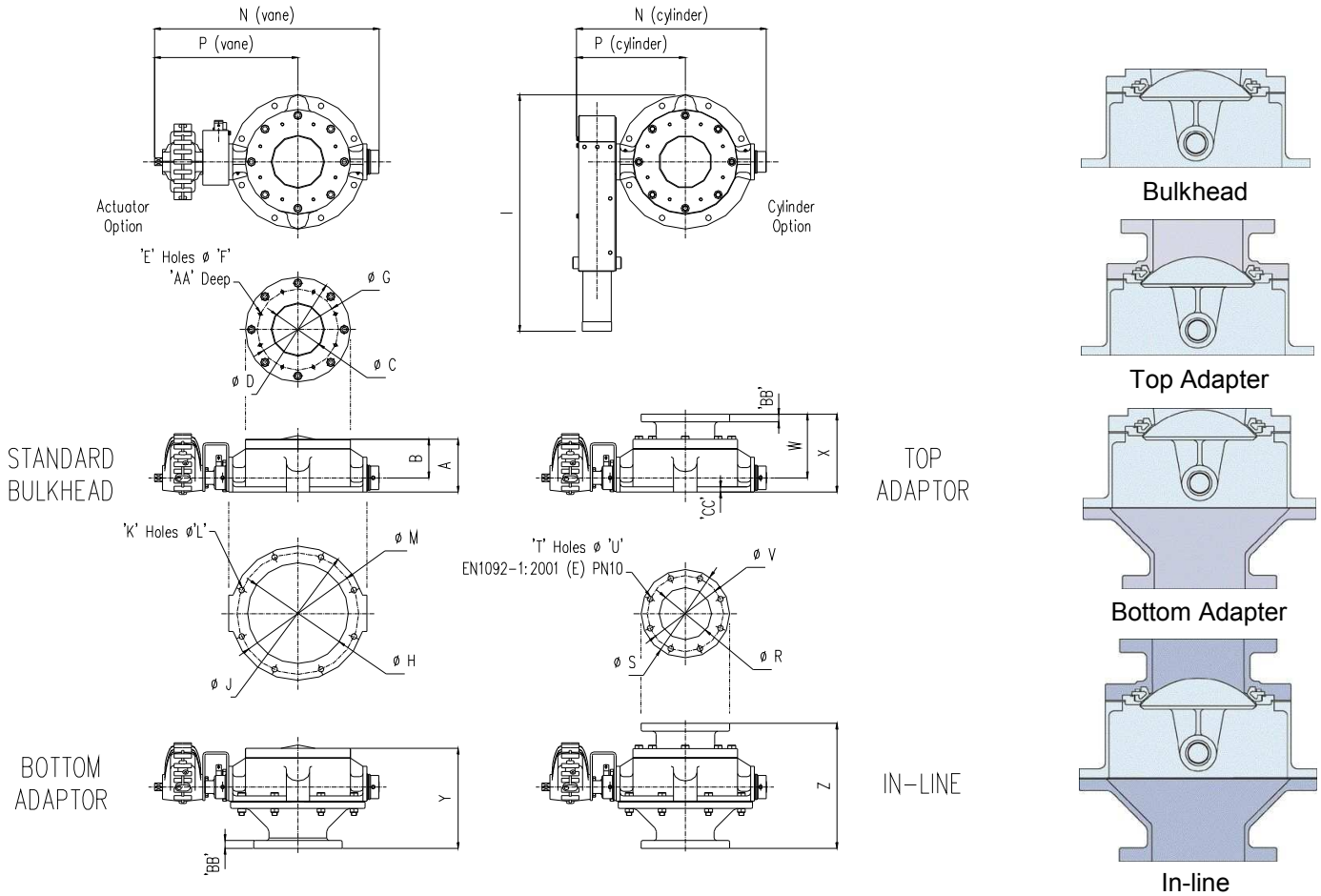

DV	A	B	Ø C	Ø D	E	Ø F	Ø G	Ø H	I	Ø J	K	Ø L	Ø M	N vane	N cyl	P vane	P cyl	Ø R	Ø S	T	Ø U	Ø V	W	X	Y	Z	AA	BB	CC	WT Kgs In-line
50		74	51	165	4	M16	125	51		165	4	18	125	373		242		50	165	4	18	125			188		23		18	17
80		90	78	200	8	M16	160	78		200	8	18	160	441		296		78	200	8	18	160			228		23		20	23
100	137	97	106	250	4	M12	200	240		340	6	18	300	608		402		103	229	8	18	180	173	213	272	348	13	26	20	60
150	169	124	157	320	6	M12	260	312		440	8	22	390	779		513		155	285	8	22	240	212	257	362	450	16	28	20	112
200	205	150	206	406	8	M12	315	390	928	520	8	22	470	870	683	555	368	203	343	8	22	295	247	302	388	485	16	30	20	197
250	249	189	260	390	6	M12	350	480	1212	620	8	26	560	1121	863	725	470	254	407	12	22	350	267	327	487	565	18	32	25	300
300	283	218	306	460	6	M16	410	551	1242	690	12	26	630	1212	963	763	514	305	483	12	22	400	339	404	558	680	18	35	28	392
350	400	315	350	595	16	M20	460	739	1508	1000	12	38	870	1613	1378	999	765	350	505	16	22	460	446	531	753	884	30	45	26	800
400	370	285	410	595	16	M16	545	739	1508	1000	12	38	870	1613	1378	999	765	400	580	16	26	515	446	531	723	884	25	45	35	830
500	484	376	508	745	20	M24	620	880	1681	1110	16	39	1030		1740		958	508	745	20	26	620	541	850	857	1273	40	38	45	1300
600	650	425	600	820	20	M27	725	992	1619	1230	24	33	1120		1922		961	600	780	20	30	725	456	881	1127	1350	45	42	52	1920
800	616	390	800	1195	24	M30	950	1476	2240	1736	32	39	1380		2690		1345	800	1015	24	33	950	621	847	1216	1447	45	42	52	2400



[www.originaldomevalve.com](http://www.originaldomevalve.com)

This leaflet is for guidance only. It does not form part of any contract and is subject to change without notice.